

County Surveyor's Record, Tillamook County, Oregon

CHAINS

N $\frac{1}{16}$ 26/27 159

(Found WEA 1/4" IP set 1921) (Fits All Calls)
~~Did Not Find Cor 50~~

We set ~~from~~ WE Anderson calls
 We chained $\frac{1}{4}$ 1332⁷² from
 Sec Cor $\frac{22}{23}$ 27/26 & 1332⁷² from $\frac{1}{4}$ Between
 27/26 & 548¹⁴ from WE Anderson

P.K. Tack To The East of Cor.
 Cor Fall in N.S. Fence Line
 I set 2" IP with 4x4x48 white
 Cor post Scribe N/6 26 & 27.

1st No. of Cor New BT.
 Telephone Pole #20 N 18W 87⁶²
 87⁵⁶ Field 1970
 Telephone #21 N 80E 67⁰⁵
 66⁸⁸ Field 1970

S.A. Skinner 7/13/65
 G. Arthur

A 180
 A-747

Found 1/4" IP \odot^3 Sly & \odot^3
 Ely of our IP

BOOK 5

N $\frac{1}{16}$	27 26
T 1 S	R 9 W

In 1965, G. Arthur and S. Skinner looked for N $\frac{1}{16}$. They did not find the corner. After referring to county MAPS A-180 & A-747, G.A. and S.A.S. chained 1332⁷² from Section corner $\frac{22}{23}$ 27/26, chained 1332⁷² from $\frac{1}{4}$ corner 27/26, and chained 548¹⁴ from W.E. Anderson P.K. Tack which is located east of corner. "548¹⁴" refer to Kenneth Ross co-ordinate sheet sections 22, 23, 26, & 27. S.A.S. and G.A. set a 2" Iron Pipe, Set post, and Made Bearing objects as follows:

- 4x4x48 Post $\pm 1^{\circ}$ North of corner
- Tele-Pole #20 N 18°W 87⁶²
- Tele-Pole #21 N 80°E 67⁰⁵

Later S.A.S. and G.A. found WE Anderson Iron Pipe \odot^3 southerly and \odot^2 easterly of 2" (SAS) Iron Pipe. 2" (SAS) Iron Pipe was then removed, leaving WE.A. Pipe
 1970 - George Uvey and G. Arthur field checked bearing objects. WEA 1/4" IP. o.k.
 4x4x48 Post North 1° \triangle scribed Post $\frac{1}{16}$ 27 & 26
 Tele Pole # 20 N 18W 87⁵⁶ \triangle
 Tele Pole # 21 N 80E 66⁸⁸ \triangle

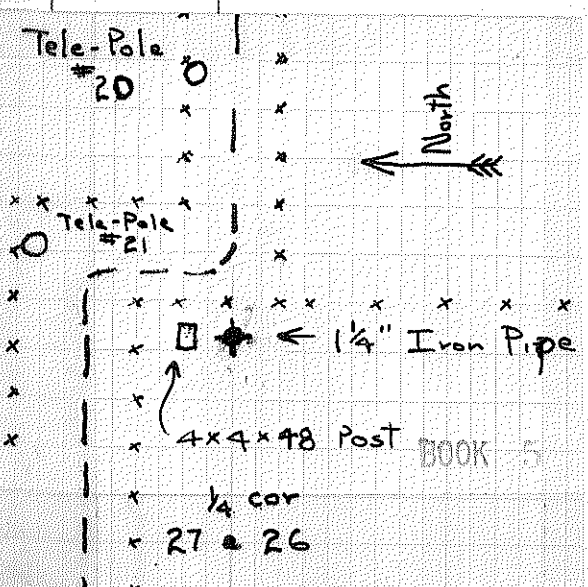

BOOK 5